

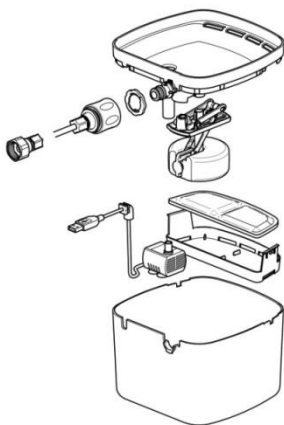

**Automatic Fill Pet Water Fountain
With Installation Kit
Only for Indoor Use**

**AF-200
AF-205**

Instruction Manual



Please read this manual before use

<https://www.hamcomfg.com>

Contents

Overview	03
Important Safety Instruction	04
Product Introduction	07
Product Installation Steps	09
Maintenance and Cleaning	13

Overview

Thank you for purchasing the “Hamco AF200 /AF205 Automatic Fill Pet Water Fountain”.

- AF220 / AF205 is for indoor use only. It is not recommended for outdoor use as outdoor dust can easily cause water pollution.
- AF200 / AF205 has a multi-layer filter cartridge, which contains 1. high-density filter cotton: can filter impurities in the water, 2. natural jellyfish activated carbon particles: can effectively filter chlorine and eliminate odor, 3. ion exchange resin: can soften the water quality , reduce heavy metals and provide fresh and clean water for pets.
- AF200 / AF205 has a safe and reliable automatic water filler that will automatically replenish water to the water tank at any time. You don't have to worry about the danger of insufficient water.
- All parts of AF200 / AF205 are made of NSF or FDA food grade materials to ensure that pet drinking water is not contaminated.
- Hamco AF series can be connected together to give each pet its own fountain and maintain your pets' health.

Important Safety Instruction

1. Before using it, please ensure that you have checked and installed all the parts and accessories of the AF200 / AF205 Auto-Fill pet water fountain. **(Refer to the 'Product Installation Steps' as shown.)** This will help prevent issues like water leakage, insufficient water levels, and overflow during automatic refilling, or operational failures etc.
2. Before plug in the power, please make sure that both your hands and the plug are dry to prevent electric shock.
3. Before cleaning or replacing the filter cartridge, the power supply and quick connectors should be disconnected.
4. The power adapter and USB plug must not be flooded during cleaning.
5. Only qualified tap water sources can be used and the water storage equipment (water towers...) in residential buildings must be cleaned regularly every 6-12 months and there is no risk of contamination.
6. In the event of windstorms, floods or other special circumstances, when the competent authority instructs that tap water must be boiled before drinking, or if your pet is immunocompromised, it is recommended not to connect the tap water source and boil the tap water before pouring it into the drinking fountain for your pet to drink. .

Important Safety Instruction

- 7.** Please use indoors only. Clean and maintain it every 2-4 weeks regularly, and replace the filter cartridge to ensure the smooth operation of the fountain and provides clean drinking for your pets.
- 8.** Replace the Installation set (LLDPE tube, quick connector, ...) every year to provide clean drinking water for your pets.
- 9.** To prevent cross-infections and maintain your pets' health, it is recommended that each pet has its own water fountain.
- 10.** AF200 / AF205 come with a 1/2-inch Female threaded connector. If your faucet does not have a 1/2-inch Male threaded connector, please purchase an adaptor that can connect to a 1/2-inch female threaded connector before connecting to the faucet and HAMCO AF200 / AF205
- 11.** Please always turn on the faucet when using this device; it will automatically fill the water tank at any time. You don't have to worry about the danger of insufficient water.
- 12.** Before using the filter cartridge, please rinse it with water and soak it in water for 5-10 minutes.
- 13.** After completing the entire assembly, then turn on the faucet. Allow the faucet water to fill the tank until the water level reaches to flood the pump, which will take about 5-10 minutes. Then, plug in the USB power supply.

Important Safety Instruction

14. AF200 / AF205 quick connectors have a water-stop function. When cleaning, you only need to pull out the quick connector on the fountain lid without turning off the faucet.
15. Place the product on a flat surface when the equipment is being used.
16. The USB cable clip should be fixed in the recess of the water tank wall. Do not move the position of the USB cable clamp (too long USB cable inside the tank will interfere with the operation of the automatic water filler and prevent it from refilling or water overflowing). (**Refer to “Product Installation Steps” Step1).**
17. Ensure that the "automatic water filler" securely pressed into the fountain lid, as it may cause to water overflow during the water replenishment process. (**Refer to “Product Installation Steps” Step3)**
18. Ensure that the Fountain lid and the tank are securely fixed together. If they are not tightly connected, it may lead to water overflow during the water replenishment process. (**Refer to “Product Installation Steps” Step5 as shown)**
19. Please use the food grade installation kit provided by HAMCO to connect the faucet, Do not use non-food grade water tube such as garden hose..., as it will lead to water pollution.